

CBD20J-H Electric Pallet Truck

Characteristics:

1. The truck has compact structure and small turning radius, suitable for narrow space;
2. Electric lifting limit function: when the fork rises to the top, the system will automatically cut the lifting circuit, with high safety, low energy consumption and long service life;
3. Adopt is simple, economic and high reliable;mechanical steering
4. Emergency stop switch and emergency reverse device as standard configuration.ensure truck safety;
5. Auxiliary wheels on both sides to improve driving stability;
6. AC drive system has light operation and excellent performance;
7. Long operating handle is ergonomic and comfortable for operation.



CBD20J-H

Manufacturer's Data and Design Characteristics

| Characteristics | | | |
|-------------------|--|------------|--------------------------|
| 1.1 | Manufacturer | | HELI |
| 1.2 | Model | | CBD20J-H |
| 1.3 | Operator type | | 步行式 Pedestrian propelled |
| 1.4 | Rated capacity | Q (kg) | 2000 |
| 1.5 | Lift height | h3 (mm) | 200 |
| 1.6 | Service weight with battery | kg | 520 |
| 1.7 | Load centre | c (mm) | 600 |
| 1.8 | Axle centre to fork face | x (mm) | 962 |
| 1.9 | Wheel base | y (mm) | 1388 |
| 1.10 | Controller | | CURTIS |
| Wheels | | | |
| 2.1 | Wheels type | | Polyurethane |
| 2.2 | Driving wheel size | Φ×w(mm) | Φ230×70 |
| 2.3 | Bearing wheel size | Φ×w(mm) | Φ80×70 |
| 2.4 | Additional wheels(dimensions) | Φ×w(mm) | Φ100×40 |
| 2.5 | wheels, number front/rear (x = driver) | | 1x+2/4 |
| 2.6 | track width, rear, loading side | b11 (mm) | 390/525 |
| Dimensions | | | |
| 3.1 | Overall length | l1 (mm) | 1742 |
| 3.2 | Length to fork face | l2 (mm) | 592 |
| 3.3 | Overall width | b1 (mm) | 700 |
| 3.4 | Fork dimensions | s/e/l (mm) | 50/160/1150 |
| 3.5 | Width of forks | b5 (mm) | 550/685 |
| 3.6 | Lowered height | h13 (mm) | 85 |
| 3.7 | Min.Ground clearance | m2 (mm) | 35 |
| 3.8 | Height drawbar in driving position min./max. | h14 (mm) | 825/1278 |
| 3.9 | Aisle width with pallet 1000 x 1200 across forks | Ast (mm) | 1944 |
| 3.10 | Aisle width with pallet 800 x 1200 along forks | Ast (mm) | 1994 |
| 3.11 | Min.Turning radius | Wa (mm) | 1556 |
| Performance | | | |
| 4.1 | Travel spees,with/without load | (km/h) | 4.2/4.5 |
| 4.2 | Lifting speed, with/without load | (mm/s) | 21/27 |
| 4.3 | Lowering speed, with/without load | (mm/s) | 38/38 |
| 4.4 | Max. Gradeability laden/unladen | (%) | 8/15 |
| 4.5 | Service brake type | | Electromagnetic brake |
| Drive and Battery | | | |
| 5.1 | Drive motor,output s2 60 min. | (kW) | 1.3 (AC) |
| 5.2 | Lift motor rating at s3 15% | (kW) | 0.8 (DC) |
| 5.3 | Battery according to din 43531/35/36 a,b,c,no | | no |
| 5.4 | Battery voltage/rated capacity | (V/Ah) | 24/210 |
| 5.5 | Battery weight (± 5%) | (kg) | 195 |
| Others | | | |
| 6.1 | Type of drive control | | AC |
| 6.2 | Sound pressure level at driver's ear | (dB(A)) | ≤70 |
| 6.3 | Steering type | | Mechanical steering |

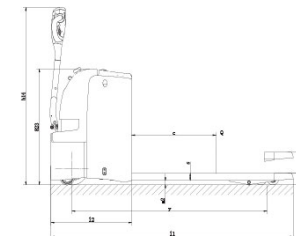
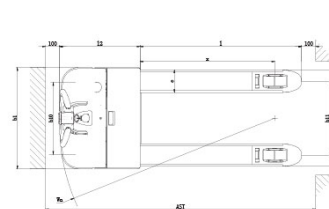

ANHUI HELI CO., LTD.
Add / No.668, FangXing Road, Hefei, China
Fax / +86-551-63639966

Tel / +86-551-63639068(America); 63639258(Europe);
63639358(Asia); 63662105(Africa & Middle East);
63639530(Key Accounts Division); 63662105(Wheel loader)